

FAQ

Grinder

[Common]

Q. Can I grind soy beans, sesami, etc. other than coffee beans with coffee grinder?

A. We have developed our coffee mills especially for coffee beans. Please refrain from using it for other purposes.

Q: For how many years can the mill be used?

A: The mill is made of iron called malleable cast iron or ceramic. If you use it carefully, it will last long. However, if you drop it or give sharp impact to it, it may break or crack.

Q. What are the advantages of a ceramic mill?

A. Unlike a metal mill, a ceramic mill does not generate much static electricity even in winter when air is dry. With little static electricity, coffee grounds do not spread.

Q. Please provide some guidelines for adjusting a mill for fineness of coffee grounds.

A. Please see below:

-Preparation-

1. Remove the locking screw, handle, and stopper.
2. Pull up the axis and turn the adjustment nut clockwise until it stops. (Be careful not to fasten it too hard.)

3. Place the locking legs onto the recessed part of the adjustment nut.

*If the prong of the locking ring and the dents of the adjustment nut do not match, please loosen the adjustment nut by turning it counter-clockwise.

-Adjustment-

4. Lift up the stopper closest to the shaft, turn the adjustment nut counterclockwise and lower the locking legs to the next recessed part = 1 notch on the scale

5. For fine grounds, turn the adjustment nut to the fourth notch on the scale and fix it. For medium grounds, turn it to the seventh notch on the scale.

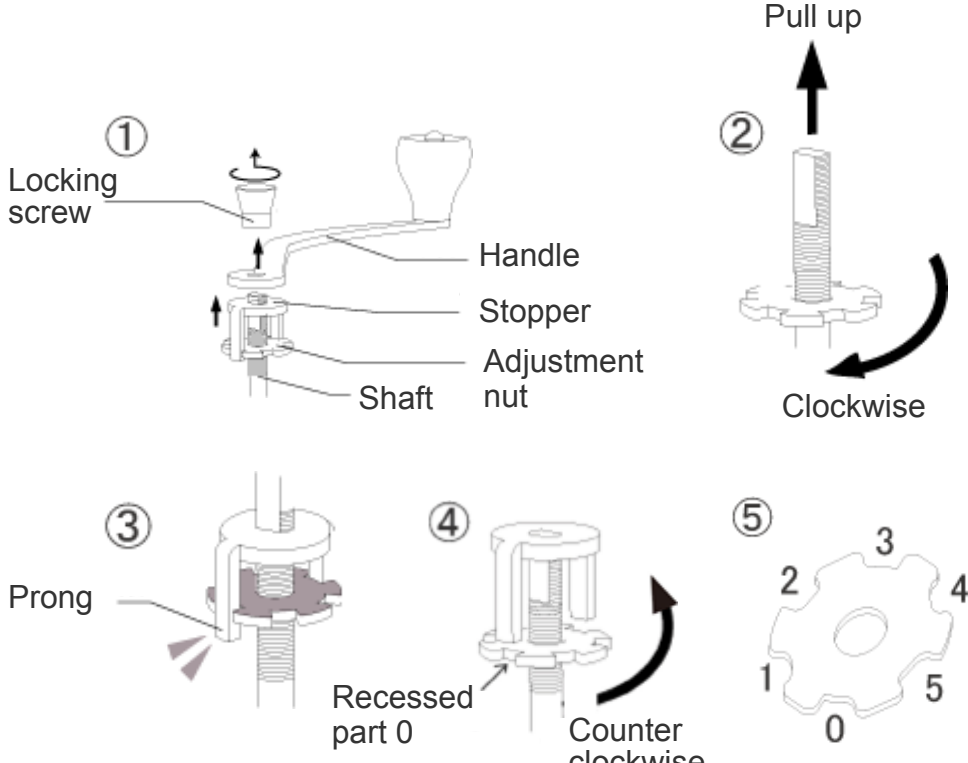

Below are guidelines for adjustment:

- Fine grounds → 4th notch on the scale
- Medium fine grounds → 7th notch on the scale
- Medium grounds → 9th notch on the scale
- Medium coarse grounds → 11th notch on the scale

[Warning!]

Please be very careful not to fasten the adjustment nut too hard. It may damage the mill.

Q. The adjustment screw loosens during use. Why is this?

A. Please confirm whether or not you applied the screw upside down.



[Ceramic Coffee Mill Skerton_MSCS-2TB]

Q. Please let me know how to use, disassemble, and wash a Ceramic Coffee Mill Skerton (MSCS-2TB).

A. Please refer to the following:



[Coffee Mill Ceramic Slim_MSS-1B]

Q. The bottle of the MSS-1B has a crack. How did it happen?

A. The bottle is made of an acrylic material. Please do not wipe or clean the bottle using alcohol, a toluene solution, etc. because it may deform, damage, or crack it. An impact or strong pressure may also cause it to crack.